

Canon

PowerShot A1100 IS
Camera User Guide



ENGLISH

- Make sure you read this guide before using the camera.
- Store this guide safely so that you can use it in the future.

File Name: canon powershot a1100 is manual mode.pdf

Size: 1754 KB

Type: PDF, ePub, eBook

Category: Book

Uploaded: 19 May 2019, 18:53 PM

Rating: 4.6/5 from 712 votes.

Status: AVAILABLE

Last checked: 7 Minutes ago!

In order to read or download canon powershot a1100 is manual mode ebook, you need to create a FREE account.

[Download Now!](#)

eBook includes PDF, ePub and Kindle version

☐ [Register a free 1 month Trial Account.](#)

☐ [Download as many books as you like \(Personal use\)](#)

☐ [Cancel the membership at any time if not satisfied.](#)

☐ [Join Over 80000 Happy Readers](#)

Book Descriptions:

We have made it easy for you to find a PDF Ebooks without any digging. And by having access to our ebooks online or by storing it on your computer, you have convenient answers with canon powershot a1100 is manual mode . To get started finding canon powershot a1100 is manual mode , you are right to find our website which has a comprehensive collection of manuals listed.

Our library is the biggest of these that have literally hundreds of thousands of different products represented.



Book Descriptions:

canon powershot a1100 is manual mode



Camera User Guide. AAsize Alkaline Batteries x2 AV Cable AVCDC400 DIGITAL CAMERA Solution Disk Memory Card 128 MB Wrist Strap WS800 Warranty "Canon Customer Card Support" Leaflet. If there is a problem with the camera while abroad, please return it to the country of sale before proceeding with a warranty claim to a Canon Customer Support Help Desk. For Canon Customer Support contacts, please see the customer support list supplied with your camera. Chapters 4 onward explain the advanced functions, letting you learn more as you read each chapter. Checking the Package Contents.2 Read This First.3 What Do You Want to Do.4 Safety Precautions.8 1 Getting Started.11. If the batteries are left inside the camera, damage caused by leakage may occur. The latter part of this chapter explains how to shoot and view images in Easy Mode, how to shoot and view movies and how to transfer images to a computer. The memory card will pop up. Compatible Batteries AAsize alkaline batteries and Canon AAsize NiMH batteries sold separately pp. 36, 38. Can any other batteries be used. We cannot recommend the use of any other batteries than those listed above because performance varies widely. Can you check the number of shots that can be taken. You can check the number of shots that can be taken when the camera is in a Shooting Mode p. Since the dates and times recorded into your images are based on these settings, be sure to set them.Set the playback mode. Press the 1 button. To take images that are in focus, be sure to first press the shutter button lightly halfway to focus, then take the shot. If you just press the shutter button fully without pausing halfway, the image may not be in focus. The camera can also detect and focus on faces, setting the color and brightness to optimal levels. Pressing the l button while turning on the camera power will turn off all sounds except for warning sounds. The subject is too far away for the flash to reach.<http://XN--B1AGA5ADIN6B.XN--P1AI/userfiles/dual-1209-service-manual.xml>

- **canon powershot a1100 is manual mode, canon powershot a1100 is manual model, canon powershot a1100 is manual models.**



Switching to and from playback mode Pressing the 1 button while the camera is off turns the camera on in playback mode. Pressing it again turns the camera off. Pressing the shutter button halfway while in playback mode causes the shooting screen to reappear. Please note that erased images cannot be recovered. Exercise adequate caution before erasing an image. Select the playback mode. Select an image to erase. CanonBrand PictBridge Compliant Printers Sold Separately By connecting your camera to one of the Canonbrand PictBridge compliant printers below, you can print your images without having to use a computer. Compact Photo Printers SELPHY series For more information, visit your nearest Canon retailer. Shooting Time Select the E mode. Select the playback mode. Transferring Images to a Computer Macintosh CameraWindow will appear when a connection between the camera and computer is established. AV Cable AVCDC400 Interface Cable IFC400PCU DIGITAL CAMERA Solution Disk AC Adapter Kit ACK800 Compact Power Adapter CAPS800 Power Cord. This product is designed to achieve excellent performance when used with genuine Canon accessories. Some accessories are not sold in some regions, or may no longer be available. However, the brightness of the image on the screen, and the brightness of the actual image recorded may be different. The menu items are organized under tabs, such as for shooting 4 and playback 1. Muting Sounds Adjusting the Volume Display the menu. Are there functions that cannot be reset. Formatting initializing a memory card erases all data on the memory card. As you cannot retrieve the erased data, exercise adequate caution before formatting the memory card. Copy the images from the memory card to a computer or other device before formatting. K Shooting in Special Conditions The camera will select the necessary settings for the conditions in which you wish to shoot when you select the matching mode. What if the indicator blinks orange and a flashing appears. <http://dreamnightwear.com/userfiles/dual-1210-turntable-owners-manual.xml>



When you press the shutter button halfway in low light conditions where camera shake is likely, the indicator will blink orange and a flashing Attach the camera to a tripod to prevent it from moving. Once inserted, however, they cannot be deleted. Digital TeleConverter The focal length of the lens

can be increased by an equivalent of 1.5x or 2.0x. This enables a faster shutter speed and less chance of camera shake than the zoom including digital zoom used by itself at the same zoom factor. The camera will activate approximately 10 seconds after the shutter button is pressed. You can change the delay time and number of shots taken p. 73. Press the p button. What if a face is not detected. Even if your face is not detected after joining the subjects, the shutter will release approximately 30 seconds later. AE stands for Auto Exposure. What if the shutter speed and aperture value are displayed in red. If a correct exposure cannot be obtained when pressing the shutter button halfway, the shutter speed and aperture value display in red. If you select Converter p. 59. Changing the Image Quality Compression Ratio You can select from the following two levels of image quality Fine, Normal. Select the recording pixels. Automatically sets the optimal white balance for the shooting Auto conditions. Day Light Fine weather conditions, outdoor shooting Cloudy Cloudy, shady, twilight conditions Tungsten Tungsten, bulbtype 3wavelength fluorescent lighting Warmwhite fluorescent, coolwhite fluorescent, warmwhite. My Colors Off Emphasizes the contrast and color saturation for a vivid Vivid impression. Neutral Tones down the contrast and color saturation for neutral hues. Sepia Sepia tones. You can now recompose and shoot. This is called Focus Lock. Shooting Using the Viewfinder If you want to save battery power, you can use the viewfinder for shooting, instead of the screen. This is effective for focusing on a specific point. What if the display does not magnify.

Confirming the number of detected faces Keeping the 0 button pressed will display the number of faces detected by the camera 35 at the most green main subject's face, white detected face. Evaluative Center Weighted Avg. Under some conditions, the image may appear coarse or the exposure setting may not be suitable. You can correct recorded images p. Redeye correction may be applied to other red parts than red eyes. The latter part explains how to specify images for printing. Searching 9 Images at a Time Jump Bar When the jump bar displays, holding the m button and pressing the qr buttons jumps to the first or last set of images. Each image displays for approximately 3 seconds. Switches between images without transition effect. Fades one image out and the next in. The image slides out to the left and the next image appears. If you press the qr buttons during playback, the image will switch. Press the l button, and switch to the focus check display p. 43. A white frame will appear where the AF frame or face was when the focus was set. Switches between images without a transition effect. Slides images left or right when the qr buttons are pressed. Protected images cannot be erased with the camera's erase function. To erase an image, cancel protection first. Since erased images cannot be recovered, exercise adequate caution before erasing. Protected images p. 96 cannot be erased. \ Rotating Images You can change the orientation of an image and save it. Easily Add Images to the Print List with c Print Added Images The following examples use the Canon SELPHY series printers. Please also refer to the Personal Printing Guide p. 2. Number of copies to print Select an image. You can then print all the selected images at once or take the memory card to a photo developer to order prints. Make print settings. The first part of this chapter explains convenient and commonly used functions. The latter part explains how to change shooting and playback settings to suit your purposes.

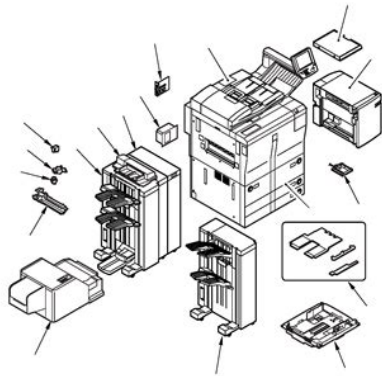

<http://eco-region31.ru/bosch-prosilence-66-manual>

Turning off the Power Saving Function You can set the power saving function p. Turning off Auto Rotate When you play back images on the camera or a computer, images shot in vertical orientation automatically rotate and display vertically. You can turn off this function. Changing the Image Display Right After Shooting You can change the image display that appears after shooting. The index also appears at the end. Do not unplug the power cord or adapter plug with the camera turned on. This could erase images you have taken or damage the camera. If the items below do not solve your problem, contact a Canon Customer Support Help Desk as listed on the included customer support list. Power You pressed the power button, but nothing happened. Press the power button to turn the camera off and back on p. 40. If this error message continues to display, contact your Canon Customer Support Help Desk as there may be a problem with the lens. This page requires Javascript. Modify your browsers settings to allow Javascript to execute. See your browsers documentation for specific instructions. To install your download click on the name of the downloaded file. Access your account, or create a new account, click here to get started. Figures for Movie Mode represent total capacity of the particular media. Canon, DIGIC, PIXMA, PowerShot and SELPHY are registered trademarks of Canon Inc. Mac is a trademark of Apple, Inc., registered in the United States and other countries. Recommended Software File Name Date File Size Optional Software File Name Date File Size Recommended Manuals File Name Date File Size Optional Manuals File Name Date File Size The Product purchased with this limited warranty is the only PowerShot Digital Camera to which this limited warranty applies. Warranty exchange or replacement does not extend the original warranty period of the Product. The sole warranty, if any, with the respect to such nonCanon brand items is given by the manufacturer or producer thereof.

<http://ferienwohnung-dorsten.com/images/bwc-manual.pdf>

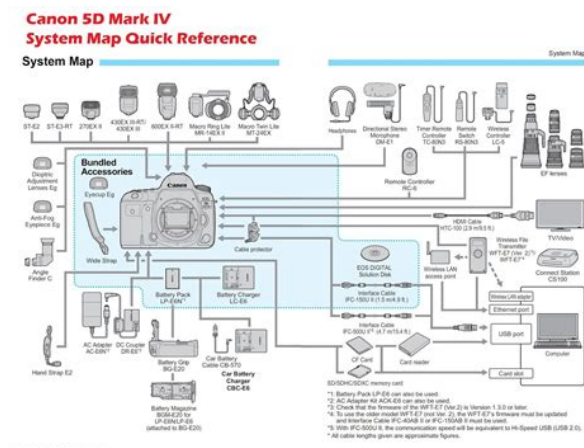

This limited warranty covers all defects encountered in normal use of the Products, and does not apply in the following cases A Canon Customer Care representative will attempt to diagnose the nature of the problem and correct it over the telephone. If the problem cannot be corrected over the telephone, you will be asked to follow the applicable procedures for MAILIN SERVICE. Note that a dated proof of purchase is required at the time of service. MAILIN SERVICE is a program under which your Product is repaired by a Canon U.S.A. or a Canon Canada authorized service center for the Product. You will be given the name, address and phone number of an authorized service center. It is your responsibility to properly package and send the defective Product, together with a copy of your dated proof of purchase, a complete explanation of the problem and a return address to the authorized service center at your expense. Do not include any other items with the defective Product. The Product covered by this limited warranty and proven to be defective upon inspection will be repaired and returned to you without charge by the authorized service center. Any Product received by the authorized service center that is not covered by the limited warranty will be returned unrepai, or at the discretion of the authorized service center, you may receive a written estimate of repair at such cost as the service center may establish from time to time. Scroll down to easily select items to add to your shopping cart for a faster, easier checkout. Visit the Canon Online Store Provides uninterrupted power for shooting or downloading. It allows viewing of recorded images from the Canon Powershot Digital Cameras. Effectively doubles the flash range of the camera. Comes with mounting bracket. The cable connects to your camera and to the USB port on your PC or MAC Computer.

<https://kinetictr.com/images/bx-25-parts-manual.pdf>



Comes standard with the EOS 1Ds Mark III, 1D Mark IV, 1D Mark III, 1Ds Mark II, 1D Mark II N, 1D Mark II, 5D Mark II, 7D, 5D, 50D, 40D, 30D, 20D, 10D, Digital Rebel XTi, Digital Rebel XT and

Digital Rebel. Please see Compatibility tab for compatible models. Canon PowerShot A1100 IS equipped with a 12.1 MP CCD sensor and advanced DIGIC 4 Image Processor drives responsive operation, superb image quality and color reproduction. The 4x 35140mm optical zoom lens gets you close to the action quickly. The Optical Image Stabilizer keeps photos sharp by reducing the effects of camera shake throughout the zoom range. The PowerShot A1100 IS features Smart Auto, which intelligently selects the proper settings for the camera based on 18 predefined shooting situations, so you can take great photos with the press of a button. Other highlights include 2.5inch LCD screen, Optical Viewfinder, Easy mode, Face Detection, Auto RedEye Correction and iContrast Intelligent Contrast Correction dynamic range enhancement. If anything is missing, contact the retailer from which you purchased the camera. AAsize Alkaline Memory Card Camera Batteries x2 128 MB Interface Cable AV Cable Wrist Strap IFC400PCU AVCDC400 WS800 Getting Started DIGITAL CAMERA Warranty "Canon Customer Solution Disk Card Support" Leaflet Also refer to the PDF manuals on the CDROM. After installation, shortcut icons appear on the desktop. Please note that Canon Inc., its subsidiaries and affiliates, and its distributors are not liable for any consequential damages arising from any malfunction of a camera or accessory, including memory cards, that results in the failure of an image to be recorded or to be recorded in a way that is machine readable.

Warning Against Copyright Infringement The images recordCaution Denotes the possibility ofIn the event that a battery leaks and the eyes, mouth, skin or cThe latter part of this chapter explains how to shoot and view images in Easy Mode, how to shoot and view movies and how to transfer images to a computer. Check the card's writeprotect tab. If the memory card has a writeprotect tab, you will not be able to record images if the tab is in the locked position. Slide the tab up until you hear a click. Open the cover. Slide and hold the cover lock, then slide and open the cover as shown. Insert the memoRemoving the Memory Card. Push the memory card in until you hear a click, then slowly release it. You can check the number of shots that can be taken when the camera is in a Shooting Mode p. 20. Number of shots that can be takeTurn on the camera. Press the power button. Set the date and time. Press the qr buttons to select an option. Press the op buttons to set a value. Change the date and time. Follow Steps 2 and 3 on p. 16 to adjust the setting. To close the menus, press the n button. Set the playback mode. Press the 1 button. Display the settings screen. Press and hold the m button, then press the n button. Set the display language. Press the opqr buttons to select a language, then press the m button. Once the display language has been set, the language menu will close. You can also change the display language by pressing the n button, selecting the 3 tab, To take images that are in focus, be sure to first press the shutter button lightly halfway to focus, then take the shot. Press halfway lightly to the first stop. The camera automatically makes the necessary settings for shooting, such as focusing and setting the brightness. When the camera focuses, it will beep twice and the indicator will light green. Press fully to the second stop.

<http://juliesteban.com/wp-content/plugins/formcraft/file-upload/server/content/files/1627272e46e710---bresser-binocom-manual.pdf>

The camera plays the shutter sound aThe camera can also detect and focus on faces, setting the color and brightness to optimal levels. Turn on the camera. Press the power button. The startup sound will play, and the start up screen will appear. Pressing the power button again will turn the camera off. Select the A mode. Set the mode dial to A. When. But the A1100 is still small enough to easily slip into a coat pocket or bag. Canon PowerShot A1100 IS On the back of the camera, you'll find a 2.5inch LCD screen and a set of controls. Canon has done a good job of standardizing the control layout and onscreen interfaces across their pointandshoot line, which means that the time you spend learning the A1100 will serve you well if you ever use another Canon pointandshoot. Shooting with the A1100 The A1100 offers the standard assortment of automatic features. From the mode dial, you can choose between Auto mode, Program mode, Movie mode, and a number of scene

modes. In Auto mode, the camera will make every critical exposure and setting choice for you, while Program mode lets you manually set ISO, white balance, flash use, and other settings. The camera lacks priority or manual modes, but it does let you adjust exposure compensation, which is often all you need to adjust for certain types of scenes. With the mode dial, you can select from five different scene modes, or choose SCN, which allows access to even more scene modes that are chosen from an onscreen menu. A scene mode simply sets the camera's exposure settings based on specific situations. Portrait, for example, tries to choose exposure settings that will yield a softer background. Canon provides far fewer scene modes than other vendors, but the choices cover just about any situation you might encounter, and having fewer options makes it easier to remember what each one does. The A1100 IS has a 2.5inch LCD.

The camera has a nice feature set, offering three different light meters, but eschewing more complex features such as focusing modes. The camera's autofocus is very good, and a button on the back of the camera lets you activate Face Detection, which automatically focuses on faces in your scene. Like face detection mechanisms, the A1100's works well when it works. In good light, it will almost always work fine, but in lower light situations, you might find it a little frustrating. The camera's 4x zoom lens offers a very nice range, from fairly wide to surprisingly telephoto for a camera this small. The lens is optically stabilized, meaning it includes special mechanics that can counteract hand shaking. Canon's stabilizer is excellent, and does a lot to deliver sharper pictures, especially in low light. You can even use it with the camera's very good video mode, which shoots 640 by 480 video with sound. The camera's 2.5inch LCD screen is OK; I found it to be a little washed out, which made seeing fine details a little difficult, especially in bright daylight. The A1100 provides an optical viewfinder, a very welcome feature when shooting in situations that make the LCD screen difficult to see, and it's not bad. It only shows about 85 percent of your final scene, but that 85 percent crop is from the very middle of your scene, rather than offcenter as it is on some Canon cameras. When reviewing an image, a halfpress of the shutter button pops you immediately back into shooting mode. This is how a camera should work, and it means you never have to worry about missing a shot while reviewing images. Image quality should always be your primary concern when making a camera choice, and in this regard the A1100 delivers. Its 12megapixel sensor packs enough pixels for very large prints you can easily use the camera's photos as 13by19inch prints.

Color is very good, and the camera's lens delivers good sharpness and suffers from no discernible distortion, vignetting, or chromatic aberration. We photograph a complex still life, a target resolution chart, and a mannequin to see how well each camera captures details and subtle coloring such as skin tones. A panel of judges reviews onscreen and printed photos and assigns imagequality scores; we then average those scores.—Lab testing performed by Tony Leung Shooting up to ISO 400 is surprisingly clean, and even higher speeds, such as 800 and 1600, are very usable, even in low light. Certainly there are cameras that perform better at these speeds, but they're also much more expensive. Read our affiliate link policy for more details. We give you the scoop on what's new, what's best and how to make the most out of the products you love. Canon A1100 IS was introduced to market in February 2009 and Canon A1200 was launched in January 2011. There is 23 months difference between A1100 IS and A1200 so we don't expect to see a huge technology difference between these two cameras but it would still give an advantage to younger A1200, especially in sensor tech. If weather sealing is a must-have feature for you, check these sections Top Compact Cameras with Weather Sealing On the other hand, with a max aperture of f2.70, Canon A1100 IS is faster at widest end. Both cameras include the new Smart Auto mode an improved Easy mode, Motion Detection and Face Detection that can detect up to 35 faces. This allows both models to deliver fast, responsive operation and outstanding, rich, detailed images. Replacing the A1000 and A2000 respectively, the PowerShot A1100 IS is available in blue, pink or silver, while the PowerShot A2100 IS features a classic black design. With a 4x optical zoom, the PowerShot A1100 IS delivers a

range of flexible framing options, while the PowerShot A2100 IS delivers extra telephoto reach via a 6x optical zoom.

Canon's optical Image Stabilizer technology helps guard photos against the blurring effects of camera shake. Also featured are Motion Detection and Face Detection Technology, both of which offer improved performance thanks to DIGIC 4 processing. Motion Detection Technology prevents blur by registering camera or subject movement and adjusting settings to compensate; Face Detection Technology detects up to 35 faces in a frame and automatically adjusts key focus and exposure settings so everyone looks their best. These take care of all the technical aspects of shooting in a host of common shooting situations. Users can choose to simply point and shoot for terrific results. Designed for convenience Both models feature high quality movies, capturing 30 frames per second for smooth results. Full PictBridge support means users can print directly to any PictBridge compatible printer without the need for a PC. Memory Card Support In addition to SD, SDHC and MMC memory cards, the PowerShot A1100 IS and PowerShot A2100 IS support MMCplus and HC MMCplus card formats. Both cameras are supplied with a memory card. Software and CANON iMAGE GATEWAY The PowerShot A1100 IS and PowerShot A2100 IS come bundled with the following Canon Software Full PictBridge support means users can print directly to any PictBridge compatible printer without the need for a PC. Software and CANON iMAGE GATEWAY The PowerShot A1100 IS and PowerShot A2100 IS come bundled with the following Canon Software For as long as most users can remember, AUTO mode has been a feature of point and shoot cameras allowing minimal intervention or expertise needed to achieve satisfactory focus and exposure. Since the introduction and rise of digital photography, there have been many technological advances and additional shooting modes, yet AUTO mode remains the staple favourite of many snappers. Research conducted by Canon also reveals that AUTO is one of the most frequently used shooting modes.

Cameras with IQ From today Canon are making AUTO mode different. The latest range of Digital Still Camera products launched incorporate a new smart system that uses Scene Detection Technology, which along with other advanced Canon technologies, leads to one of the most comprehensive and clever AUTO modes ever seen on a digital camera. Whilst complex in technology, Smart AUTO still delivers the peace of mind and ease of use for point and shooters that has always been expected from selecting the familiar green icon mode. With intelligent and integrated use of key functions such as focus, exposure, ISO sensitivity, flash, dynamic range adjustments and Intelligent Contrast Correction, Canon Cameras have never been so smart. Added to these Canon Motion Detection and Face Detection Technology plus advanced Noise Reduction, together with pleasing colour rendition all delivered by the DIGIC 4 processor, mean when selecting AUTO mode on these latest models, users can be assured of the best in image quality even in more challenging shooting conditions. Smart Auto overview Using Scene Detection Technology, Smart AUTO can distinguish parameters allowing the camera to carry out optimum processing for a shot by See price on Amazon.com Canon PowerShot A1100 IS Green See price on Amazon.com Silver See price on Amazon.com Pink See price on Amazon.com Be the first to write one! Read our full review to see why its got the best autofocus system weve ever seen. 716 Olympus OMD EM10 Mark IV initial review first impressions Aug 4, 2020 at 0600 The Olympus OMD EM10 IV is the companys entrylevel DSLRshaped mirrorless camera. While it has a higher resolution sensor and new processor, its biggest focus is on selfies. 2258 Sony a7S III initial review Jul 28, 2020 at 1400 The Sony a7S III is a 12MP fullframe camera primarily designed with video in mind. We take a look beyond the specs to see what it offers to filmmakers.

1608 Olympus OMD EM1 Mark III review review Jul 27, 2020 at 1450 The Olympus OMD EM1 Mark III is our favorite Micro Four Thirds camera for stills shooters to date. In this roundup we take a look at four travel tripods and pick our favorite. In our latest buying guide weve selected some cameras that might be a bit older but still offer a lot of bang for the buck. These midrange cameras should

have capable autofocus systems, lots of direct controls and the latest sensors offering great image quality. Best cameras for sports and action Aug 11, 2020 at 0146 Whats the best camera for shooting sports and action. Fast continuous shooting, reliable autofocus and great battery life are just three of the most important factors. In this buying guide weve roundedup several great cameras for shooting sports and action, and recommended the best. Best enthusiast long zoom cameras Jul 16, 2020 at 2329 Longzoom compacts fill the gap between pocketable cameras and interchangeable lens models with expensive lenses, offering a great combination of lens reach and portability. Read on to learn about our favorite enthusiast long zoom cameras. There is a possible workaround, but its not convenient and up to individual developers. Aug 20, 2020 37 Lightroom CC update for iOS, iPadOS permanently deletes photos and presets for some users Lightroom 5.4 on iOS and iPadOS was meant to be a standard update, but for some users, it meant losing their entire photo library and presets. A new version, Lightroom 5.4.1, is already available, preventing the issue from happening to additional customers, but Adobe says that it cannot recover the lost data. Aug 19, 2020 19 lens news Oppo shows off its nextgeneration optical zoom camera module with 85135mm equivalent focal length The camera module, which has an 85mm through 135mm fullframeequivalent focal length range, also features an updated version of Oppos Hybrid Zoom technology that results in clearer images.

Aug 19, 2020 56 mobile Panasonic will announce, via livestream, its new Lumix S5 fullframe camera on September 2 Panasonics new Lumix S5 fullframe camera system will be revealed via a livestreamed event on September 2, 2020. Aug 19, 2020 245 camera news Sony a9 II review The Sony a9 II didnt make a huge splash in the industry when it launched, but its certainly left an impression on us. Read our full review to see why its got the best autofocus system weve ever seen. Aug 19, 2020 735 review ZTE to launch the first smartphone with underdisplay front camera on September 1st After weve seen prototype designs from Xiaomi and Oppo, rival ZTE is now the first manufacturer to launch a device featuring the new technology. Aug 18, 2020 83 mobile Report Air Force One nearly collided with a drone, investigation launched On Sunday night, witnesses on board Air Force One spotted a drone. The White House has launched an investigation into the near collision. Aug 18, 2020 389 Tamron 24mm F2.8 M12 sample gallery Introduced alongside 20mm and 35mm siblings, the Tamron 24mm F2.8 is a lightweight and lowcost option for fullframe Sony shooters. Aug 18, 2020 57 sample gallery New York City map makes it easy to find historical images of NYC from 1939 to 1941 The map uses the NYC Municipal Archives digitized collection of historical photos captured by the NYC Tax Department. Aug 17, 2020 43 Case dismissed against George Steinmetz, whose drone was confiscated for documenting mass burials Back in April, awardwinning photographer George Steinmetz had his drone confiscated for documenting mass burials on Hart Island. Charges have since been dropped and his drone has been returned. Aug 17, 2020 58 Video How to thoroughly clean and disinfect your camera Olympus Europe has partnered with photographer Fernando Marmolejo to create a video guide on how to keep your cameras and lenses clean and disinfected.

<http://superbia.lgbt/flotaganis/1649290177>